

## HDM-SPLITPRO-4A

4x1 HDMI Quad Multiviewer Scaler with  
Rotation and Chromakey



## MULTIVIEWER SCALER

### KEY FEATURES

- Seamless switching and Fade In Out between input channels and combined images on single HD Monitor;
- Zoom IN/Out the (4) four HDMI Input Channels;
- Supports PIP, POP, PAP and Multi-windows layout configurations;
- Rotation (90° left & right and 180°) functions;
- Supports Chromakey Function;
- Mirror the (4) four HDMI Input Channels;
- 8 Preset Hot keys for easy control and design layouts;
- 4 Custom Favorite saved layout buttons via the IR Remote;
- Input /Output resolution supported supports full range of video resolutions up to WUXGA@60 (RB) or Full HD 1080p;
- Audio Supports LPCM 2CH, 6CH, 8CH/AC3/DTS/Dolby Digital Plus/Dolby TruHD & DTS-HD;
- Fine tuning and adjustments of contrast, brightness, Saturation and hue;
- USB for Service Mode and Firmware upgrade;
- Supports OSD, RS-232, Telnet, IR Remote and Front panel buttons;
- Factory Reset;

### HDM-SPLITPRO-4A

LAYOUT 1 SINGLE HD MONITOR  
Preset layout 1

CABLE INDEX  
■ Output  
■ Input / Source  
■ RS-232

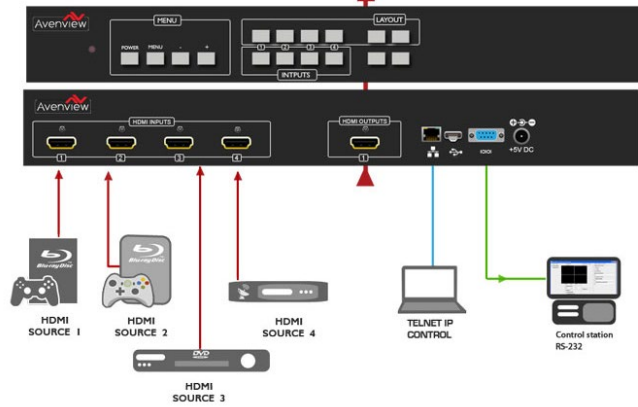
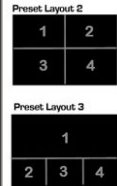

### PANEL DESCRIPTION

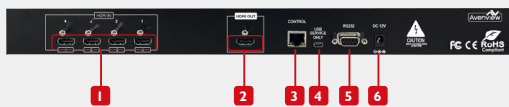

- |                           |                           |
|---------------------------|---------------------------|
| <b>1</b> HDMI In 1-4      | <b>2</b> HDMI Out         |
| <b>3</b> Ethernet Control | <b>4</b> USB Service Only |
| <b>5</b> RS-232           | <b>6</b> DC 12v           |



### ITEM

### SPECIFICATION

<b>Video Format Support</b>	HDMI, DVI
<b>Unit Description</b>	4x1 HDMI Quad Multiviewer with Rotation and Chromakey
<b>Video Bandwidth</b>	225 MHz (6.75Gbps)
<b>Input Resolutions</b>	PC -VGA, XGA (1024 x 768), SXGA (1280 x 1024), UXGA (1600 x 1200), WUXGA (1920 x 1200) 480i/720p/1080i/1080p@60
<b>Out put Resolutions</b>	480P 59Hz, 576P 50Hz, 720P 50Hz, 720P 60Hz, 1080P 24Hz, 1080P 25Hz, 1080P 30Hz, 1080P 50Hz, 1080P 60Hz, 1024X768 60Hz 1280X800 60Hz, 1280X1024 60Hz- upto 1920X1200RB Hz,Native
<b>Audio Support</b>	LPCM 2CH, 6CH, 8CH/AC3/DTS/Dolby Digital Plus/ Dolby TruHD & DTS-HD
<b>Input Connectors</b>	HDMI x1, RS-232, x1 Ethernet x 1
<b>Output Connectors</b>	HDMI x 1
<b>HDMI Input Selection</b>	Push Button / IR Remote / RS232 and Telnet Support
<b>Dimensions (L x W x H)</b>	17.16" x 10" x 1.7"
<b>Power Supply</b>	12V/3A DC
<b>Power Consumption</b>	18 Watt (max)

## HDM-SPLITPRO-4A

CHROMAKEY FUNCTION  
LAYOUT 2

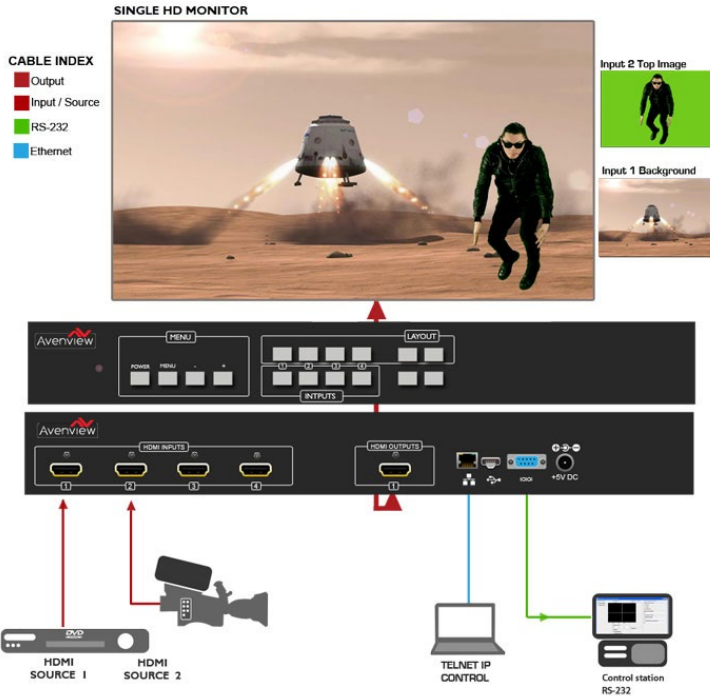

## HDM-SPLITPRO-4A

ROTATION FUNCTION  
LAYOUT 3

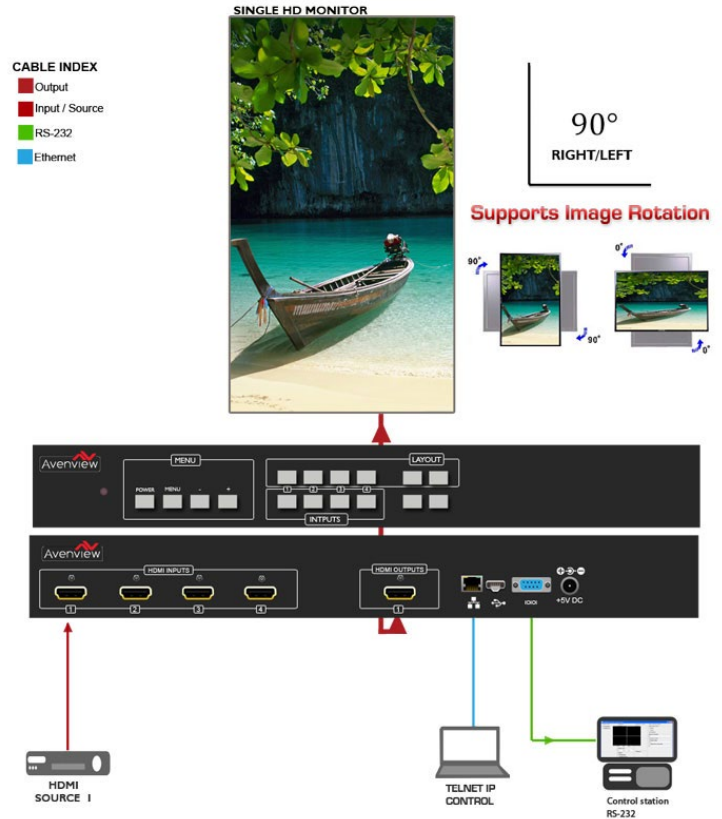

**Seamless Switching, Fade In Out** – This device can input any 4 HDMI input digital sources and then combine, (4) four video signals onto a single HDMI HD Monitor. The user will benefit with from its processing power to seamlessly switch between the 8 different Hot key function via, IR Remote, Telnet, Rs232 or Front Panel buttons.

**Zoom In/out** – This device can Zoom In/Out any 4 HDMI input digital sources and then combine, (4) four video signals onto a single HDMI HD Monitor. This device can be configured using the OSD, IR Remote, Telnet, Rs232 or Front Panel buttons to set the desired layout configuration.

**PIP,POP, Overlay** – This device can input any 4 HDMI digital sources and then combine, (4) four video signals onto a single HDMI HD Monitor, which the user can select Picture In Picture (PIP), Picture on Picture (POP) or Overlay with the OSD, IR Remote, Telnet, Rs232 or Front Panel buttons to set the desired layout configuration.

**Channel Size and Position** – The user can easily change the individual channel size and choose different position and layout on the single monitor with the OSD, IR Remote, Telnet, Rs232 or Front Panel buttons to set the desired layout configuration.

**Rotation (90° & 180°) & Mirror** – The user can easily Rotate the image 90° left and right also Mirror the image. This device can be configured with the OSD, IR Remote, Telnet, Rs232 or Front Panel buttons to set the desired layout configuration.

**ChromaKey** – This device can input 4 HDMI digital sources but only utilize (2) two Inputs for this technique layering two images or video streams together based on color hues (chroma range). Where CH1 is the background and CH 2 is the top image. This device can be configured with the OSD, IR Remote, Telnet, Rs232 or Front Panel buttons to set the desired layout configuration.

### USA Head Office

Office Avenview  
 Corp. 275 Woodward Avenue  
 Kenmore, NY 14217  
 Phone: +1.716.218.4100 ext223  
 Fax: +1.866.387-8764  
 Email: info@avenview.com

### Canada Sales

Avenview  
 151 Esna Park Drive, Unit 11 & 12  
 Markham, Ontario, L3R 3B1  
 Phone: 1.905.907.0525  
 Fax: 1.866.387.8764  
 Email: info@avenview.com

### Avenview Europe

Avenview Europe  
 Demkaweg 11  
 3555 HW Utrecht  
 Netherlands  
 Phone: +31 (0)85 2100- 613  
 Email: info@avenview.eu

### Avenview Hong Kong

Unit 8, 6/F, Kwai Cheong Centre,  
 50 Kwai Cheong Road,  
 Kwai Chung, N.T.  
 Hong Kong  
 Phone: 852-3575 9585  
 Email: wenxi@avenview.com